



Building Plot at Wildcatcleugh, Lanton Road, Jedburgh, TD8 6SD

“An edge of town building plot with expansive elevated views”

This building plot is located close to both the town centre and farmland at Lower Langshots. Located between Tudhope Loaning and Wildcatcleugh on a corner site, this quiet corner of Jedburgh has elevated views over the town towards Jedburgh Grammar Campus.

Building plot: 0.32 acres

Offers Around £120,000



WELCOME TO

OVERVIEW

Full planning permission for a single dwelling house was granted on 23rd February 2023, see Planning Permission Reference 22/00872/FUL. Copies of the planning permission and associated documents can be obtained through the Scottish Borders Council website using the planning reference quoted within these particulars. The Purchaser(s) shall be required to satisfy themselves as to the status of the Planning Permission. All mains services are understood to be nearby.



THE PLOT

The site has been prepared in anticipation of future development works with the adjustment of ground levels and the removal of the vegetation layer. This triangular shaped plot enjoys elevated views to the east and open views to the south. There are a number of mature trees in the vicinity of the site, along the edge of neighbouring land and gardens. The site is bounded to the south by Lower Landshots Field.

THE AREA

Southwest of Kinnoull and accessed from Lanton Road, this building plot is located close to Jedburgh Town Centre. It should be noted that Lanton Road has a significant gradient.

what3words

///firelight.solved.refreshed



PLAN

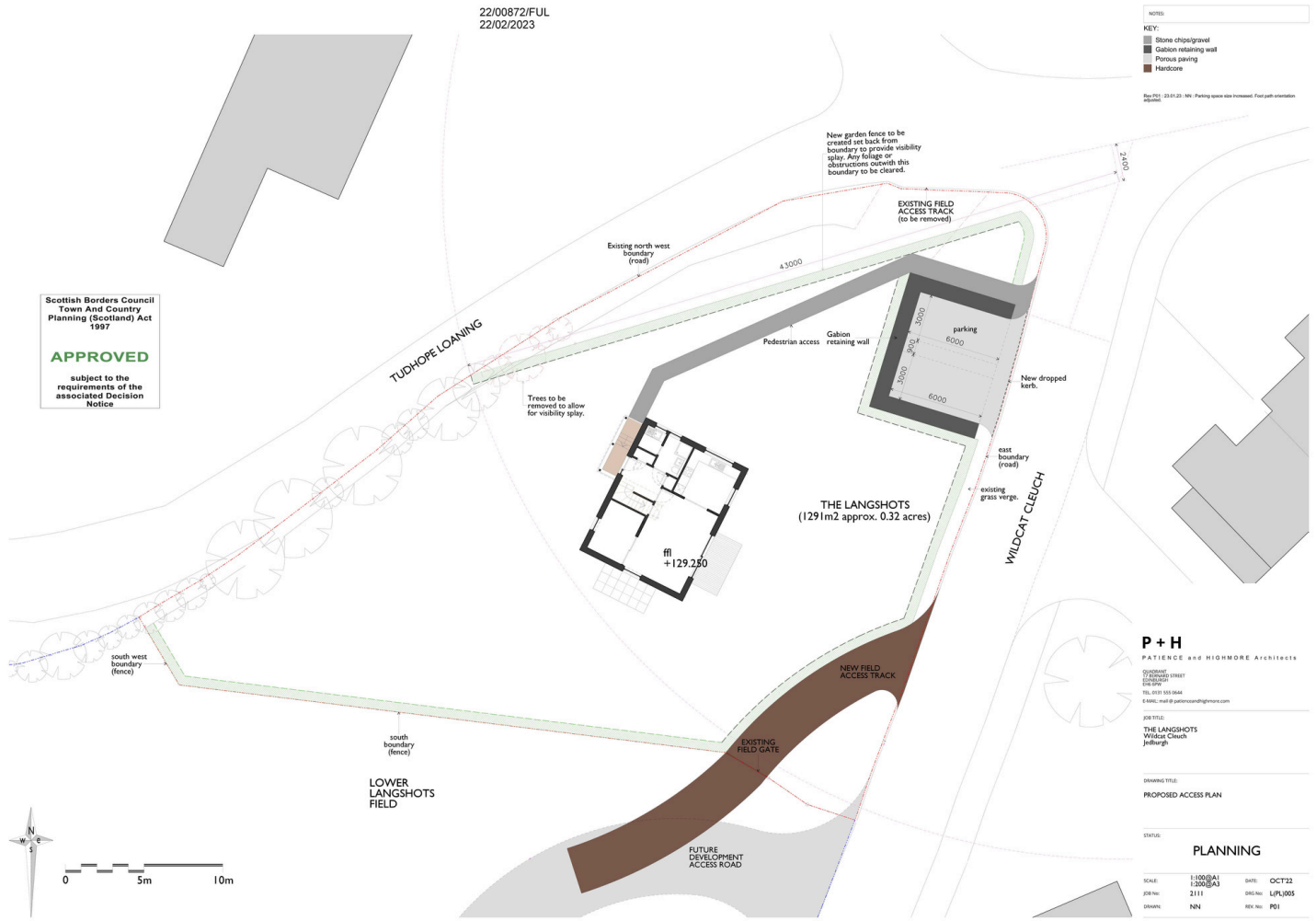

ABOUT TAIT'S

At Tait's our integrated estate agency and legal teams guide you through the buying and selling process. We strive to make the process as straightforward as possible for you and have offices in both Kelso and Jedburgh town centres. We have in-depth local knowledge of the Scottish Borders. In addition to estate agency services, we also offer private client legal services.

These particulars whilst believed to be correct are set out as a general outline only for the guidance of intending purchasers and do not constitute nor will constitute part of any offer or contract. All descriptions, dimensions and other information are given in good faith but any intending purchasers should not rely on them as statements or representations of fact but must satisfy themselves by inspection or otherwise as to their accuracy.